

High oil consumption, blue smoke at start

Fault symptoms

Increased oil consumption and/or oil leak. Blue smoke when starting the engine and accelerating.

Conditions

The following conditions apply for this fault symptom:

The fault symptoms may be caused by clogged pipes in the camshaft cover, which can produce excess pressure in the crankcase.

Diagnostic procedure

1. Remove the ignition discharge module.
2. Remove the camshaft cover.
3. Clean the two crankcase ventilation pipes. Use a 6 mm fuel hose connected to compressed air. If necessary, use a piece of wire.

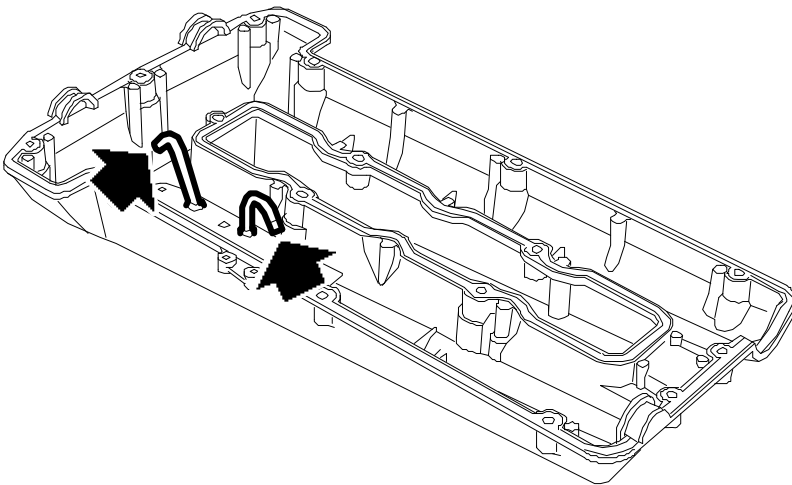

E254B047

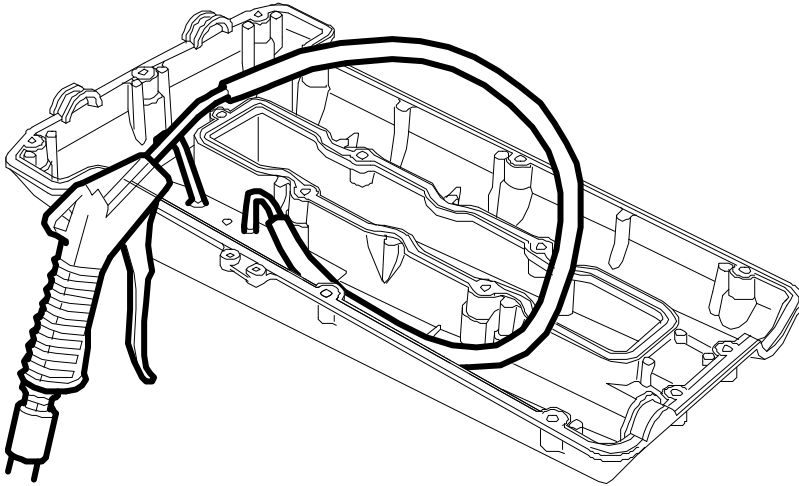

E254B048

4. Fit the camshaft cover as described under [Cylinder head](#), "For fitting cylinder heads (in situ)", steps 13-14.
5. Fit the ignition discharge module.